

1986 ROLL - TRACT 6428

M.B.293-43"VAHALLA TOWNHOUSES" CONDO.
C.C.&R.'S 12845/1 4-23-86



N20° 16' 51" W
159.36

N89° 13' 59" W
121.23

107.61
N73° 12' 09" W

N21° 57' 11" W - 196.45

PODVA ROAD

OCHO RIOS ROAD

PODVA LANE

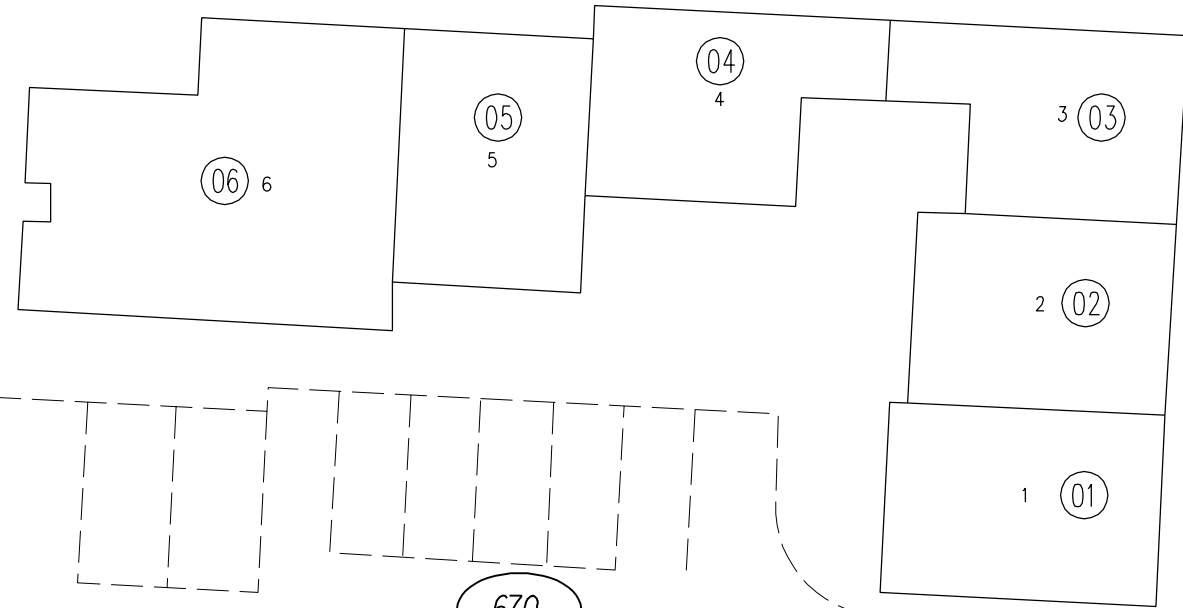

670

LOT "A"
COMMON AREA

07

0.45Ac.

51 CR 35

670

