

# TO BK. 186-17

74

360

05

DRIVE  
TERRA CALIF

ROSSMOOR  
PKWY<sup>78</sup>

DR.  
TERRA CALIF

FIRST LEVEL

SECOND LEVEL

ROSSMOOR

PKWY.

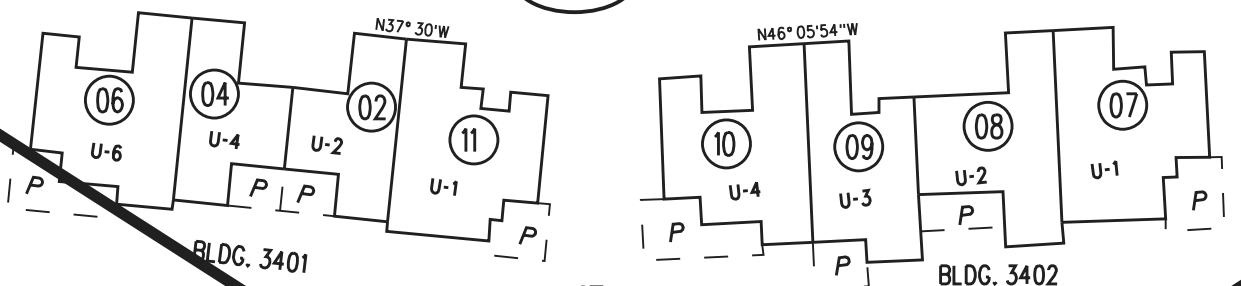

LOT 1  
1.27Ac.

360

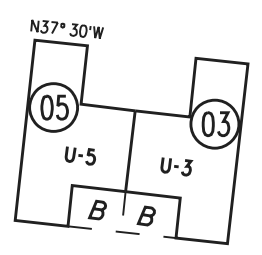

LOT 1  
1.27Ac.

SEE PAGE 05 FOR  
M/R ASSESSMENT

360

Sanborn Date : 11/06/1999 7-16-75 RS FM.189-05

ASSESSOR'S MAP

BOOK 189 PAGE 36

CONTRA COSTA COUNTY, CALIF.

