

PCL 2 TRACT 9070 MB 490-7 (VIDRIO CONDOMINIUMS)
CONDO PLAN 10-0119444 6/16/2010

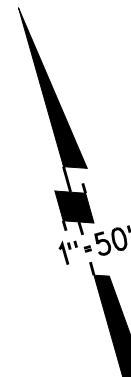

WEST SIXTH ST

EAST SIXTH ST

EAST SIXTH ST

BLACK DIAMOND ST

RAILROAD AVE

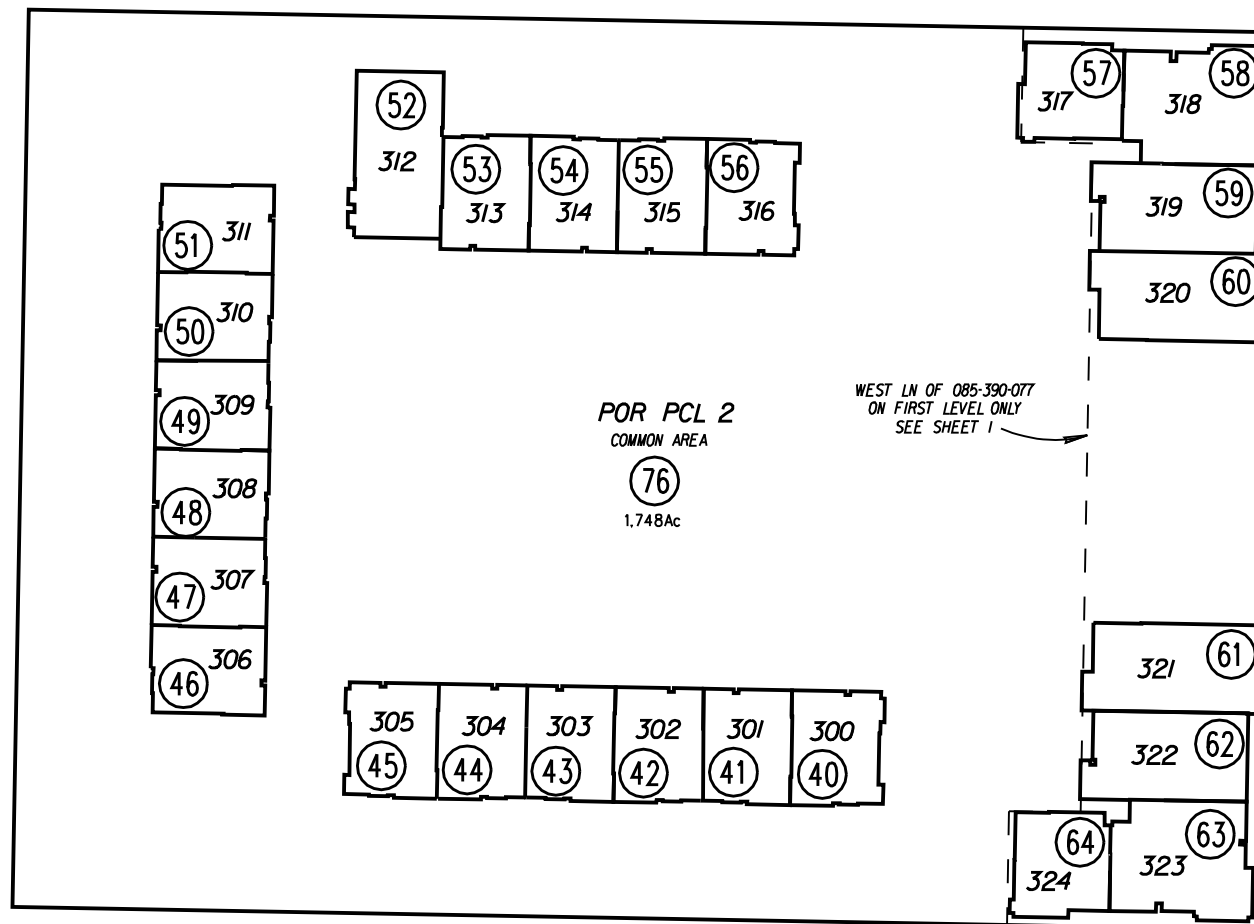

POR PCL 2
COMMON AREA
76
1.748Ac

WEST LN OF 085-390-077
ON FIRST LEVEL ONLY
SEE SHEET 1

WEST SEVENTH ST

EAST SEVENTH ST

EAST SEVENTH ST

THIRD LEVEL

NOTE: THIS MAP WAS PREPARED FOR ASSESSMENT PURPOSES ONLY. NO LIABILITY IS ASSUMED FOR THE ACCURACY OF THE INFORMATION DELINEATED HEREON. ASSESSOR'S PARCELS MAY NOT COMPLY WITH LOCAL LOT SPLIT OR BUILDING SITE ORDINANCES.

390

2/18/11

FM PG 16 9/27/10
ASSESSOR'S MAP

BOOK 85 PAGE 39 S-3
CONTRA COSTA COUNTY, CALIF.