

CORNER RECORD

Agency Index 213 CR 37
Document Number -10130

City of WALNUT CREEK County of CONTRA COSTA, California
Brief Legal Description EAST LINE OF LOT 12 - (99 M 30)

CORNER TYPE		COORDINATES (Optional)	
<input type="checkbox"/> Government Corner	<input type="checkbox"/> Control	N. _____	E. _____
<input type="checkbox"/> Meander	<input type="checkbox"/> Property	<input type="checkbox"/> Elevation _____	
<input type="checkbox"/> Rancho	<input type="checkbox"/> Other	<input checked="" type="checkbox"/> Units	Metric <input type="checkbox"/> U.S. Survey Foot <input type="checkbox"/>
Date of Survey <u>3-10-20</u>		Horizontal Datum _____	
		Zone _____	Epoch Date _____
		Vertical Datum _____	
		<input type="checkbox"/> Complies with Public Resources Code §§8801-8819	
		<input type="checkbox"/> Complies with Public Resources Code §§8890-8902	

PLS Act Ref.: 8765(d) 8771 8773 Other:

Corner/Monument: Left as found Established Rebuilt Pre-Construction
 Found and tagged Reestablished Referenced Post-Construction

Narrative of corner identified and monument as found, set, reset, replaced, or removed:
 See sheet #2 for description(s):



SURVEYOR'S STATEMENT

This Corner Record was prepared by me or under my direction in conformance with
the Professional Land Surveyors' Act on 3-12-20
Signed [Signature] P.L.S. or R.C.E. No. 7136

COUNTY SURVEYOR'S STATEMENT

This Corner Record was received March 16th 2020
and examined and filed April 14th 2020
Signed James A. Stein P.L.S. or R.C.E. No. 6571
Title County Surveyor



County Surveyor's Comment
A.P.N. 187-321-008

DONALD VEGVARY
 LAND SURVEYOR
 3527 MT. DIABLO BLVD., #368
 LAFAYETTE, CA 94549
 (925) 947-1051

CORNER RECORD

EAST LINE OF LOT 12
 'SUB. 3037' - (99 M 30)
 SURVEY DATE: MARCH 10, 2020

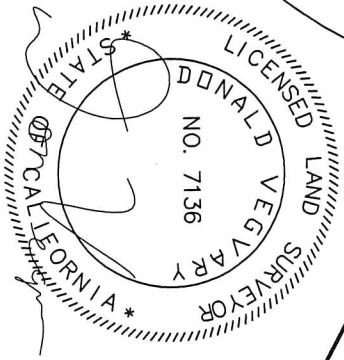

SCALE: 1"=20'

